



---

# WAGNER BAND

## **Thunderbird Invitational**

Saturday, March 19<sup>th</sup>, 2022

Karen Wagner High School

Hosted by The Wagner Band &

Wagner Band Boosters

# Wagner High School TECA Traffic Flow



# Wagner High School TECA Contest Flow

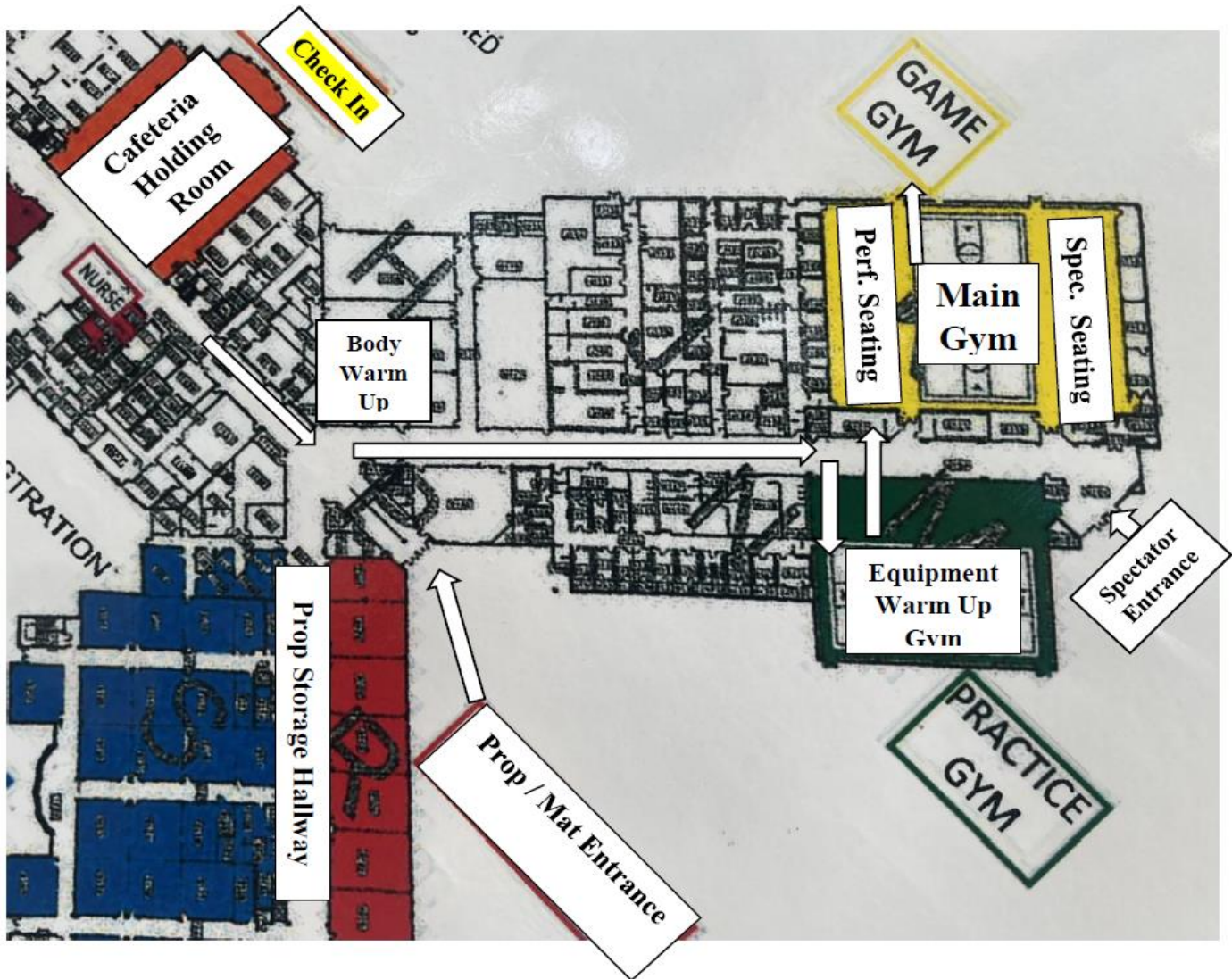

All contest rules and regulations from the 2022 TECA Constitution and By-Laws and 2022 WGI Rule Books will be followed.

### PARKING

Spectator parking is in the Wagner HS Athletic Lot located in the back part of the campus.

**GUARD:** Equipment trucks (floors and props) will be unloaded at Wagner athletic lot located in the back of the campus. After unloading floors and props, equipment trucks should park in the band lot located on the left side of the campus across the street at the marching pad.

**PERCUSSION:** Equipment trucks may park and unload in the back part of the athletic lot. First come, first served space for warm up zones and parking.

Buses should unload at the cafeteria bus loop located in the back of the campus for unit check-in, then should park at the band lot on the left side of the campus across from the marching pad.

### CHECK-IN

**GUARD:** The check-in table will be located at the cafeteria entrance. Performing members must check in prior to warm-up.

**Equipment -** At check-in, performers must show the check-in representative that equipment is appropriately padded and taped.

**PERCUSSION:** The check-in table will be located at the cafeteria entrance. Performing members must check in prior to warm-up. Signs will point the way.

Maps of the school and performance times will be available.

## PERFORMERS, CREW, & STAFF ADMISSION

Admission will be given to performers and up to 10 student crew members.

## UNIT HOLDING AREA

Each unit will have a designated area in the cafeteria to store personal items. Concessions will be available in the cafeteria

No outside food or drink is allowed in the high school.

Students and Staff<sup>5</sup> may not spin, toss, or maneuver equipment inside any of the buildings at any time other than in designated areas. You may use the area in front of the cafeteria extra equipment warmup.

## PERFORMANCE

Ready – When it is time for your group to be ready, report to the Volunteer table in the hall just outside the cafeteria

Equipment and props will be double checked for appropriate taping for protection of the gymnasium floors.

Body Warm-Up – From the volunteer table, students will proceed to body warm-up located in the Wagner dance studio. Students may stretch or do a run through of body mechanics. No equipment will be utilized during the body warm-up segment of the official warm-up time. A sound system will be available.

Equipment Warm-Up – From Body Warm-Up, students will proceed to equipment warmup. The group will be in a holding area until the Equipment Warm-Up time starts. A sound system will be available.



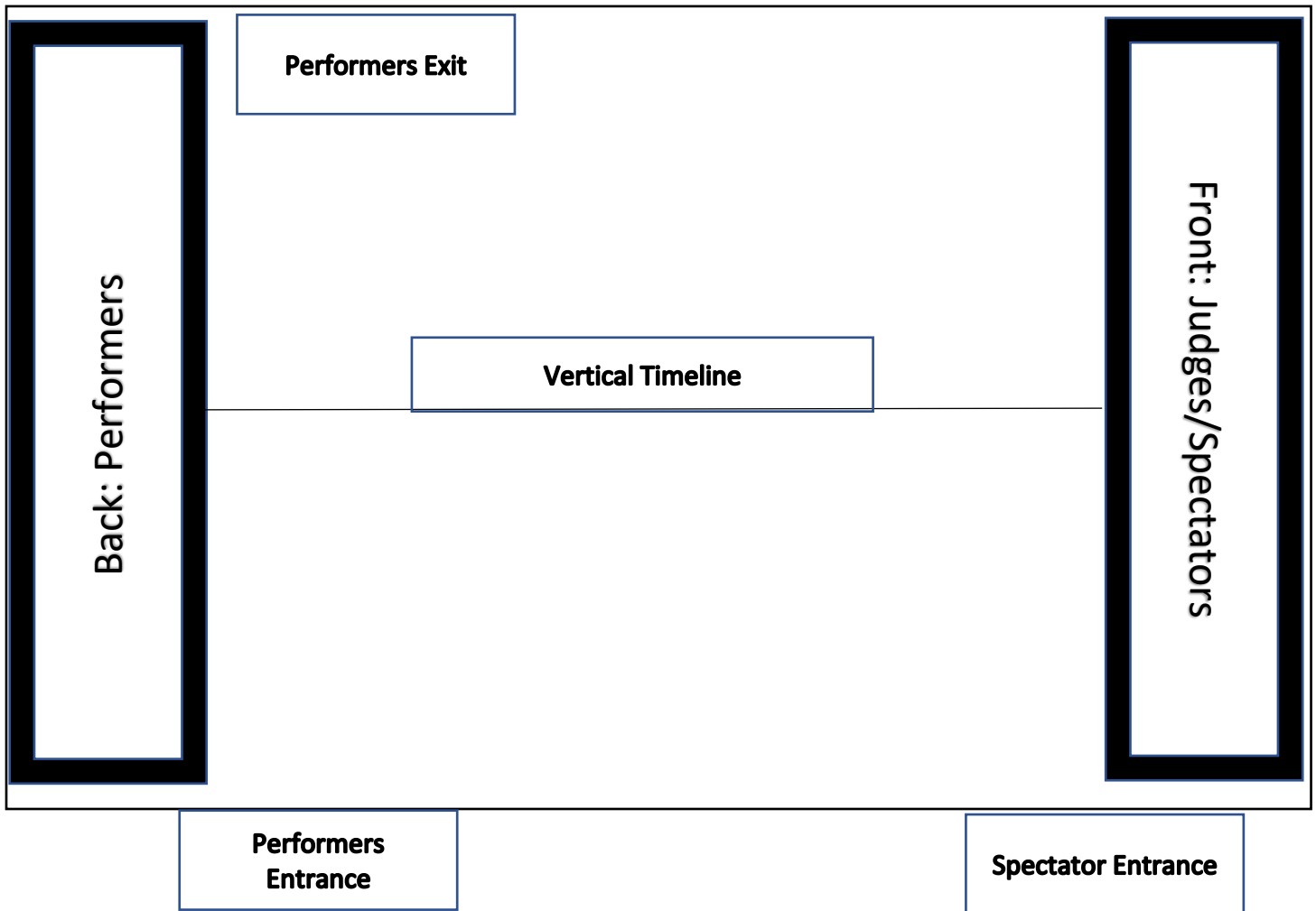

**Performance - After Equipment Warm-Up, students will be led to the performance area. The group will be in a holding area until the official set-up and performance time starts.**

**We will be using a VERTICAL Center Line Flow for the Performance Area.**

DRUMLINES: Units will warm-up on the behind Back of the athletic parking lot and will be directed to the performance gymnasium.

GUARDS: Units will enter from the area closest to Equipment Warm-Up and will exit on the opposite side.

## POST PERFORMANCE

After you exit the performance area, Staff members should make sure that equipment is put away. Guards will be directed to a floor-folding area in the parking lot. Please fold floors quickly and exit the area to prevent a "Traffic jam."

## RETREAT

Captains will line up in the warm-up gym after the last performance. Retreat should begin promptly at the conclusion.

Critique There will not be a critique at this show.

Admission (Spectators) Students - \$5.00 (children under 5 free) Adults - \$8.00

## CONCESSIONS

Concessions will be available throughout the contest at the performance gym and in the cafeteria. Outside food or drink will not be allowed inside the school.