

**Harlan High School Invitational**

**March 7, 2020**

**Harlan HS Competition Gym**



**A TECA sanctioned contest hosted by:**

**Harlan Hawk Band**

**Harlan HS Principal – Robert Harris**

**Northside Fine Arts Department**

**Director of Fine Arts – James Miculka**

**Athletic Coordinator – Eddie Salas**

**For questions contact:**

**Dr. Andrew Tucker at 618-303-3614 or [andrew.tucker@nisd.net](mailto:andrew.tucker@nisd.net)**

## *Harlan Percussion/Colorguard Showcase Information*

### LOCATION, DIRECTIONS AND MAP:

The Harlan Percussion/Colorguard Showcase will be held on Saturday, March 7<sup>th</sup> at the Harlan High School Competition Gym: **14350 Old Farm to Market Rd 471 W, San Antonio, TX 78253**

### Due to Road Construction constantly changing around Harlan:

When coming down Culebra Rd from 1604 please take the Harlan HS Detour on *Old Farm to Market Rd*. There is an electronic sign on the left side of the road that is also there to remind people to take the Detour.

The Culebra Rd entrance is only open going towards 1604



# Harlan High School Outside Entrance





# Harlan High School Outside Map



# Harlan High School – East Inside Map

## HARLAN HIGH SCHOOL

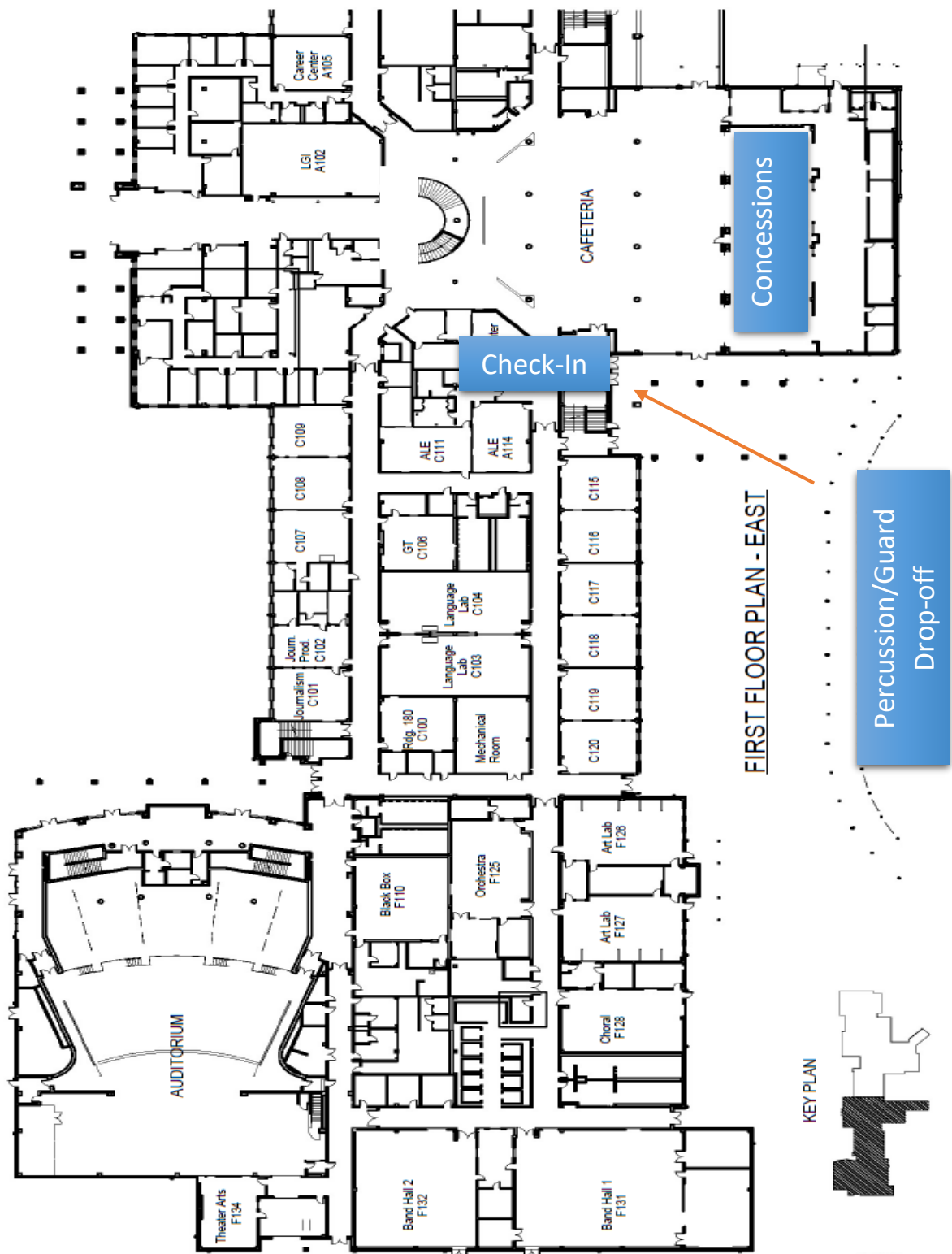

Concessions

Check-In

FIRST FLOOR PLAN - EAST

Percussion/Guard Drop-off

KEY PLAN

# Harlan High School – West Inside Map

Spectator Entrance

Performers' Exit

Spectator Seating

Concession

Horizontal Timeline

Performer Seating

Performers' Entrance

Movement

Spectator Entrance

Equipment

Equipment Check

Judge Hospitality

Check-in

Cafeteria

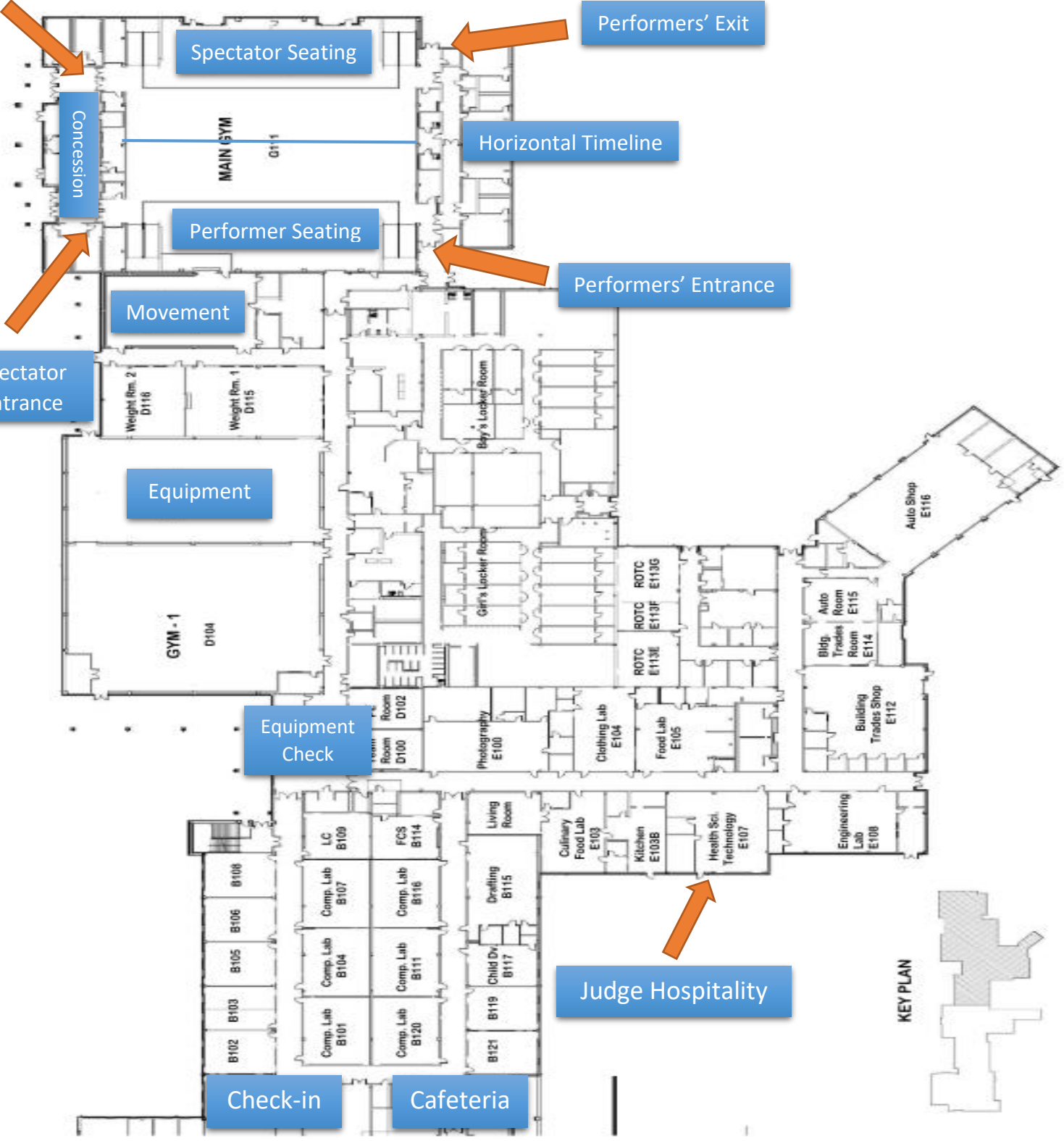
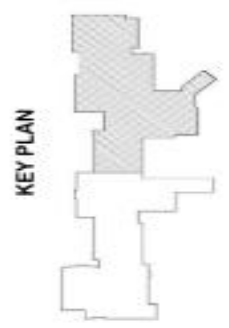

### ***Contest Information***

- All contest rules and regulations from the 2019-2020 TECA Constitution and By-Laws and the 2019-2020 WGI Rule Books will be followed.
- All Props, performance shoes and equipment must be padded and taped according to the TECA and WGI rule book specifications. Please refer to the 2019-2020 WGI Colorguard and Adjudication Manual and Rule Book for further information.

### ***Check-In***

- The check in table for guard participants will be located in Harlan High School inside by the bus loop.
- Performers will show the monitors that all equipment is properly padded and taped before they enter the gym for **Movement** in the equipment check area.
- Maps of the school and a schedule of performance times will be available at check-in.

### ***Percussion/Guard Crew and Staff Admission***

- Performing members will need to report to their table in the cafeteria prior to warm-up.
- Admission stamps will be provided for 30 performers, 2 bus drivers, and up to 10 student crew members.
- Additional admission stamps may be purchased at the check-in table for additional crew members at a cost of \$5 per student.

### ***Percussion/Colorguard Area***

- Tables will be set up in the cafeteria for each group to store personal items.
- Props/Floors and larger equipment will be stored in the Prop Storage Area outside of the Main Gym in the breezeway.

***The cafeteria and hallways are traffic areas only. Students and staff will not spin, toss or maneuver any equipment at any time other than in designated warm-up areas.***

- You may use the area **OUTSIDE** the check-in area for extra equipment warm-up

**After performance, units will be able to leave their items in the cafeteria. If you have a special circumstance, i.e. your bus is dropping you off and leaving, please contact Dr. Andrew Tucker: 618-303-3614 or [andrew.tucker@nisd.net](mailto:andrew.tucker@nisd.net) to make arrangements**



## **Official Warm-Up Time and Performance**

### ***Body Warm-Up***

- When it is time for your group to be “READY”, please report to the cafeteria
  - You will be escorted by a monitor from there to each warm-up area.
- Body warm-up will be in the Dance Studio/Cheer Studio (D117). Students may stretch or do a body type of run through.
  - **No equipment will be allowed during this segment of the official warm-up time**
- A sound system will be made available to you in the body warm-up area.

### ***Equipment Warm-Up***

- After Body Warm-Up, your group will be led to the warm-up gym and will be placed in the holding until your Equipment Warm-Up time starts
- Equipment Warm-Up will be in Gym 2 (D110)
- A sound system will be made available to you in the Equipment Warm-Up area.

### ***Performance***

- After Equipment Warm-Up, your group will be led to the performance area.
- You will be placed in holding until your official set up and performance time begins.
- Performance will be in the Main Gym (G111)

***We will be utilizing a HORIZONTAL TIME LINE flow for the performance are***

### ***Post-Performance***

- After exiting the performance area, staff and unit members should make sure that all equipment is secured.

**After performance, units will be able to leave their items in the cafeteria. If you have a special circumstance, i.e. your bus is dropping you off and leaving, please contact Dr. Andrew Tucker: 618-303-3614 or [andrew.tucker@nisd.net](mailto:andrew.tucker@nisd.net) to make arrangements**

### ***Comment and score sheets will be sent electronically***

- Unit captains will need to start their line-up underneath the seating area after the last unit of each retreat block.
- Retreat will follow the last performing group
- Participants will be given the opportunity to attend critique session hosted by the judges and TECA



### ***Spectator Admission***

- Spectators will receive a stamp at the spectator entrance.
- **ALL SPECTATORS MUST HAVE A STAMP TO ENTER THE COMPETITION**
- Admission is \$8.00 for adults and \$5.00 for students.
  - Children under 5 are free.
  - Cash, Check or Credit Cards are accepted.
    - There will be a convenience fee of 50 cents per adult tickets and 25 cents per student if a Credit Card is used. (This is a fee charged to us).

### ***Concessions/Vendors***

- Concessions will be available throughout the day outside the main gym and in the cafeteria
- Vendors will be available at the main gym.

### ***Shirts/Shout-Outs/Flowers***

- If you wish to show support and congratulate your participants, Shout-Outs in the gym will be available for purchase at \$3 for one or \$5 for two. Cash only
- Roses and Carnations will be available for purchase
  - Roses = \$3
  - Carnations = \$2
- Please make sure to bring extra money in case you are interested in purchasing any of the items listed
- Contest shirts will be available for purchase

### ***Online Help and Information***

Dr. Andrew Tucker – Director of Bands

[andrew.tucker@nisd.net](mailto:andrew.tucker@nisd.net)

Mr. Bobby Joe De Leon Jr. – Assistant Director of Bands

[bobby.deleon@nisd.net](mailto:bobby.deleon@nisd.net)

Mr. Steven Partida – Assistant Director of Bands

[steven.partida@nisd.net](mailto:steven.partida@nisd.net)

Mr. A Jay Riojas – Colorguard Director

[madgrd1987@gmail.com](mailto:madgrd1987@gmail.com)

Additional information and help is also available on the TECA Website

<http://www.go-teca.org>

## Concessions/Vendors

<b>Item</b>	<b>Price</b>
Breakfast Taco	\$2
Nachos or Frito Pie	\$3
Chick-fil-a Sandwich	\$6
Sausage Wrap	\$3
Pizza Slice	\$2
Powerade or Soda	\$2
Coffee (K-Cup)	\$2
Hot Chocolate	\$1
Bottled Water	\$1
Chips	\$1
Pickles	\$1
Candy	\$2
Cheese Cup	\$1
Pizza Combo (2 Slices, chips and water)	\$5
Chick-fil-a Combo (+chips and water)	\$7

## Vendors

TECA Merchandise Vendor

Carol Sharkey – Pretzels/Frappuccino/Cotton Candy

Lone Star Sales – Jewelry/Novelties and more!

Kona Ice – Snow Cones

Winterguard/Music related Button Vendor

Flowers

Kernal Corner – Fiesta/Cheddar/Caramel flavor Kettle Corn (\$3.00 each, 2 for \$5.00)

**\*\* No outside food or drinks allowed \*\***