

# STEELE COLORGUARD & PERCUSSION SHOWCASE

February 4, 2017



A TECA sanctioned contest hosted by:



Steele Band Boosters  
&  
Steele Knight Winter Guard

For questions contact Kris Miller at 253-444-8362 or  
[steelebandboosters@yahoo.com](mailto:steelebandboosters@yahoo.com)



## BYRON P. STEELE II HIGH SCHOOL

1300 FM 1103 Cibolo, Texas 78108 Phone (210) 619-4000 Fax (210) 619-4057 www.scuc.txed.net



Jana Cervantes  
Principal

- ★ High Achievement For All Students
- ★ High-performing and Engaged Workforce
- ★ Effective and Efficient District and Campus Operations

Welcome to Byron P. Steele II High School!

I would like to welcome all the competing groups to Steele High School for the TECA competition today. We are proud to host this competition and want to wish each and every one of you good luck in your efforts today. Steele High School appreciates your help in keeping our beautiful facility clean. If there is anything you need please do not hesitate to ask.

Welcome and good luck!

Sincerely,

Jana Cervantes

Principal

Byron P. Steele High School

★ SCUCISD Mission Statement ★

*Schertz-Cibolo-Universal City ISD provides a safe, secure and challenging learning environment, through the responsible use of all resources, to afford opportunities for all students to realize their individual potential and to become productive members of society.*

# Steele Colorguard & Percussion Showcase Information

## I. LOCATION, DIRECTIONS AND MAP:

The Steele Colorguard and Percussion Showcase will be held on Saturday, February 4, 2017 at Byron P. Steele II High School located at 1300 FM 1103 in Cibola, Texas 78108.

### From the IH-35 Corridor:

Take IH-35 to exit 178 FM 1103/Hubertus Road.  
Turn east onto FM 1103. Proceed approximately 4 miles.  
Steele High School will be located on the left side of FM 1103.  
Buses will use the second entrance located by the tennis courts.  
Spectator parking will be at the first entrance (the stoplight).

### From the IH-10/ Highway 90 Corridor:

Take IH-10 East to exit 591 FM 1518  
Turn west onto FM 1518. Proceed approximately 5.6 miles.  
Turn right onto FM 78. Proceed approximately 2.3 miles.  
Turn left onto FM 1103. Proceed approximately 1.5 miles.  
Steele High School will be on the right hand side of FM 1103.  
Buses will use the first entrance located by tennis courts.  
Spectator parking will be located at the second entrance (the stoplight).

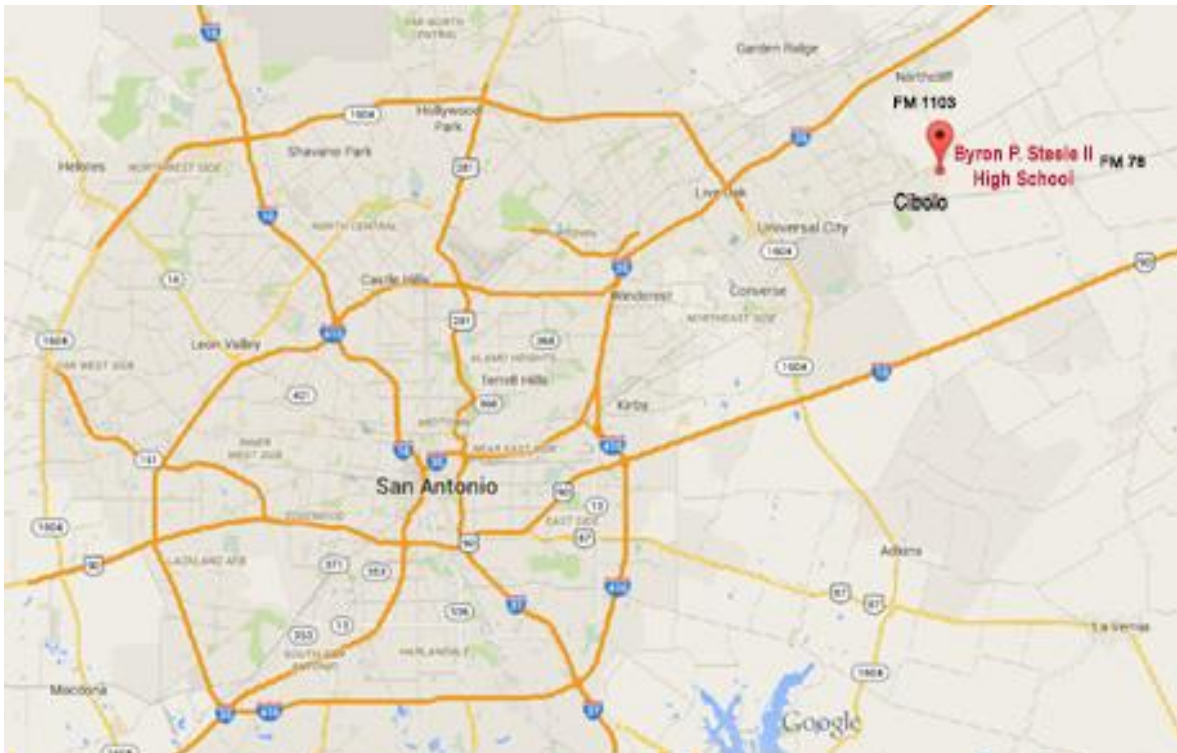

**PARKING:**

Spectators are to enter Steele High School at the school's main entrance located at the stop light/intersection of Rodeo Way and FM 1103. Spectator parking will be in the parking lot in front of the school closest to the gymnasium. Spectators will enter the school via the Courtyard Entrance.

Buses and equipment trucks are to enter at the second entrance to Steele High School located by the tennis courts. Buses and equipment trucks will be unloaded at the Check In/Drop Off point located at the front of the school and then proceed to park in the far lot.

*Byron P. Steele II Campus Map with traffic flow*

- |                                     |                                    |
|-------------------------------------|------------------------------------|
| 1. Bus and Equipment Truck Entrance | 4. Spectator Parking Entrance      |
| 2. Bus Unload                       | 5. Spectator Parking               |
| 3. Bus and Equipment Truck Parking  | 6. Spectator Entrance to Courtyard |



## **II. CONTEST INFORMATION**

All contest rules and regulations from the 2016-2017 TECA Constitution and By Laws and the 2016-2017 WGI Rule Books will be followed.

All props, performance shoes and equipment must be padded and taped according to the TECA and WGI rule books specifications. Please refer to the 2016-2017 WGI Color Guard and Adjudication Manual and Rule Book for further information.

### **CHECK IN**

The Check In table for all participants will be located at the front of the school.

Performers will show the Monitors that any equipment is properly padded and taped during warm up.

Maps of the school and a schedule of performance times will be available at check in.

### **GUARD CREW AND STAFF ADMISSION**

Performing members will need to report to the Check In table prior to warm up.

Admission bracelets will be provided for 3 directors, 2 bus drivers, and up to 10 student crew members.

Additional admission bracelets may be purchased at the Check In table for additional crew members at a cost of \$3 per student.

### **COLOR GUARD AREA**

Tables will be set up in the cafeteria for each group to store personal items.

Props/Floors and larger equipment will be stored in the Prop Storage Area in the main hallway of the school.

*The cafeteria and hallways are traffic areas only. Students and staff will not spin, toss or maneuver any equipment at any time other than in designated warm up areas.*

You may use the outer parking lot for extra equipment warm up.

## **III. OFFICIAL WARM UP TIME AND PERFORMANCE**

### **BODY WARM UP**

According to the schedule, when it is time for your group to be "READY", please report to the Ready table located in the cafeteria.

You will be escorted by a monitor to each warm up area.

Body warm up will be in the Band Hall. Students may stretch or do a body type of run through. No equipment will be allowed during this segment of the official warm up time.

### **EQUIPMENT WARM UP**

After Body Warm Up, your group will be led to the warm up gym and will be placed in holding until your equipment warm up time starts.

A sound system will be made available to you in both body and equipment warm up areas.

### **PERFORMANCE**

After Equipment Warm Up, your group will be led to the performance area.

You will be placed in holding until your official set up and performance time begins.

**We will be utilizing a verticle time line flow for the performance area.**

Performing units will enter the performance area through the back right and exit through the back left doors. (See attached Gym Flow Map)

### **POST PERFORMANCE**

After exiting the performance area, staff and unit members should make sure that all equipment is secured and then proceed to pick up the show music.

Comments and score sheets will be sent electronically.

Please use the Courtyard/Spectator Entrance to enter the Gymnasium to watch other units. Participating units are asked to sit on the opposite side from the judges to allow paying spectators the opportunity to view performances. (see flow map)

Unit Captains will need to report to the equipment warm up gym to line up for retreat.

Retreat will follow the last performing group.

Participants will be given the opportunity to attend a critique session hosted by the judges and TECA.

### **IV. SPECTATOR ADMISSION**

Wrist bands will be sold at the entrance to the gymnasium. All spectators must have a wrist band to enter the competition.

Admission is \$10.00 for adults. \$5.00 Students. Children under 5 are free.

Cash, Check or Credit Cards accepted.

## **V. CONCESSIONS**

Concessions will be available throughout the day.

No outside food or drink will be allowed inside the school.

See attached list for food items to be sold in Concessions.

## **VI. VENDORS, FLOWERS AND SHOUT-OUTS**

Various vendors will be selling a variety of items during the competition in the Courtyard, the Cafeteria and they Gym.

If you wish to show support and congratulate your participants, flowers and Shout-outs will also be available for purchase. Cash only.

Please make sure to bring extra money if you wish to purchase souvenirs, flowers, Shout-Outs or other products.

## **VI. ONLINE HELP AND INFORMATION**

Contact Kris Miller, Steele Band Boosters President, at 253-444-8362 or [steelebandboosters@yahoo.com](mailto:steelebandboosters@yahoo.com)

Steven Deater, Director of Bands, [sdeater@scuc.txed.net](mailto:sdeater@scuc.txed.net)

Linda Guerra, Guard Instructor, [lguerra@scuc.txed.net](mailto:lguerra@scuc.txed.net)

Additional information and help are available via the TECA website at: <http://www.go-teca.org>.

# TECA CONCESSION PRICE LIST

ALL DRINKS .....	\$1.00
Soda, PowerAde, Water, Iced Tea, Coffee, Cocoa	
Breakfast Taco .....	\$2.00
Bacon & Egg, Potato & Egg, Bean & Cheese	
Fresh-Grilled Hamburger.....	\$4.00
Choice of Condiments - Cheese, Onions, Pickles, Tomato	
Sausage Wrap.....	\$3.00
Frito Pie (Chili only) .....	\$2.00
With Chili and Cheese.....	\$2.50
Hot Dog .....	\$1.50
Chili or Cheese, add 50¢ each	
Nachos .....	\$2.00
With Chili.....	\$2.50
Hot Cheetos with Cheese.....	\$2.50
Muffin .....	\$1.50
Donut.....	\$1.50
Cup O' Ramen.....	\$1.00
Popcorn .....	\$1.00
Chips .....	\$1.00
Candy .....	\$1.00
Fresh Fruit.....	\$1.00
Pickle.....	\$1.00



# MAPS

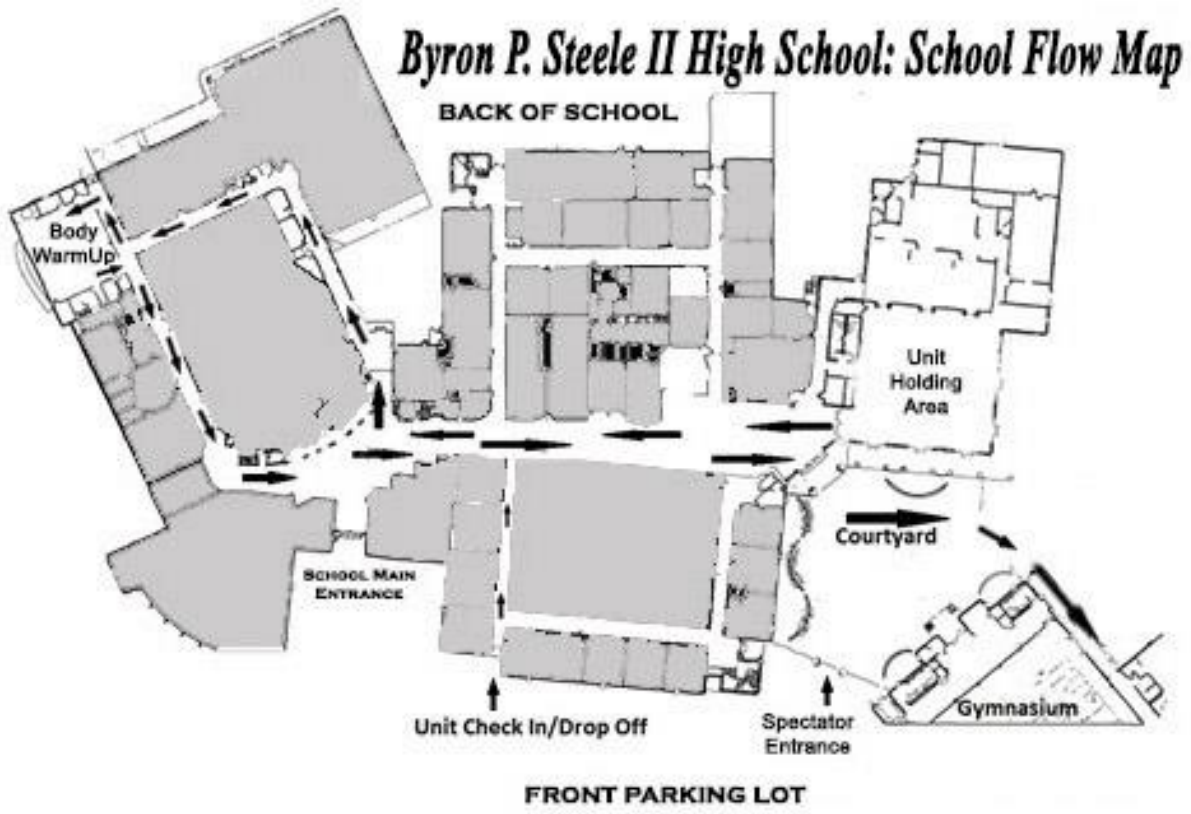

Steele High School - Gym Flow Map

Floor Folding Area

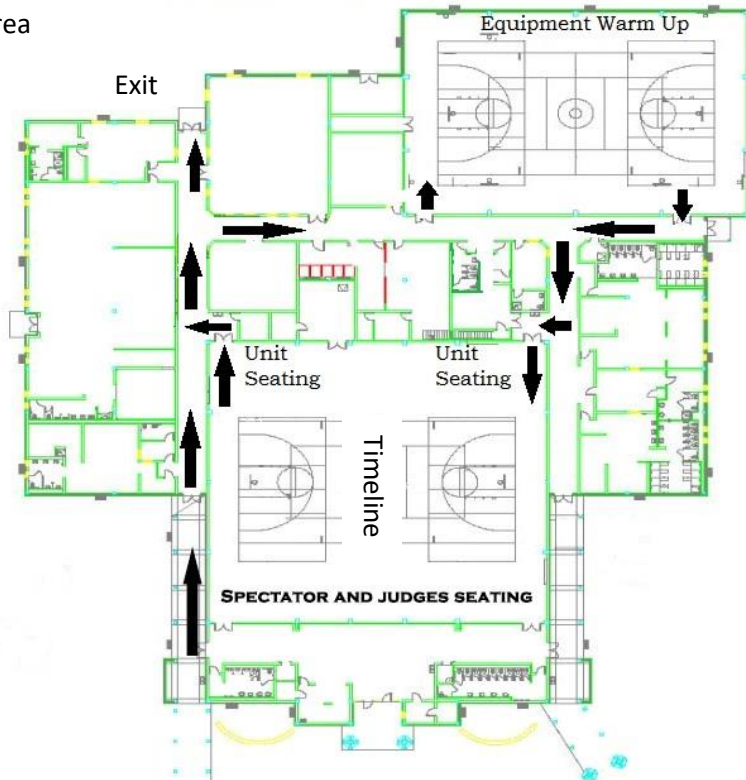

## BYRON P. STEELE II HIGH SCHOOL TECA CONTEST SITE SURVEY

Your Name:
Unit or School:

For each item identified below, circle the number that best fits your judgment of its quality.

Survey Item	Scale				
	Poor	Good			Excellent
1. Adequate Parking	1	2	3	4	5
2. Unit Lounging	1	2	3	4	5
3. Body Warm-Up Area	1	2	3	4	5
4. Timed Warm-Up	1	2	3	4	5
5. Props & Equipment Storage Area	1	2	3	4	5
6. Restrooms	1	2	3	4	5
7. Concessions	1	2	3	4	5
8. Competition Area	1	2	3	4	5
9. Display Tables Area	1	2	3	4	5
10. Critique Room	1	2	3	4	5
11. Contest Staff Hospitality Room or Directors Hospitality Room	1	2	3	4	5
12. Visibility of Contest from Stands	1	2	3	4	5
13. Adult & Student Workers and Runners	1	2	3	4	5
14. Contest Flow	1	2	3	4	5
15. Contest Packet	1	2	3	4	5
16. Overall Contest Site Rating	1	2	3	4	5

**COMMENTS:**

---



---



---



---

